



Newland Road

Bristol, BS13 9EA

£1,550 PCM



Welcome to this charming three-bedroom end of terrace house located on Newland Road in the vibrant city of Bristol.

Upon entering, you are greeted by a cosy reception room and a large Kitchen/Diner. The property boasts two double bedrooms and one single bedroom offering ample space for a growing family or those in need of a home office. One of the highlights of this property is the outside space, providing a lovely area for outdoor activities

Additionally, the property benefits from a convenient location near schools and local shops

Contact us today to arrange a viewing

Salary requirement 48k and over.



Area Map



Floor Plans

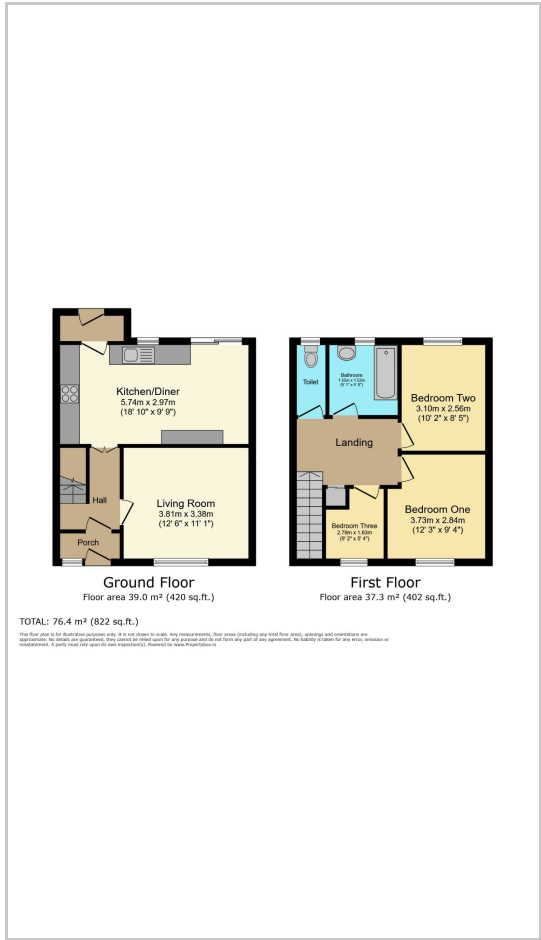

Energy Efficiency Graph

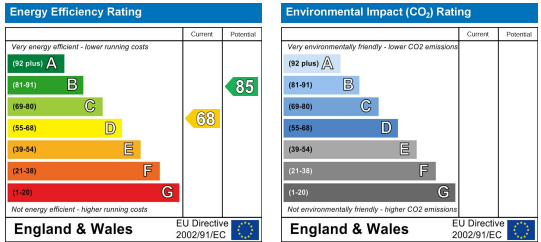

These particulars are intended to give a fair and reliable description of the property but no responsibility for any inaccuracy or error can be accepted and do not constitute an offer or contract. We have not tested any services or appliances (including central heating if fitted) referred to in these particulars and the purchasers are advised to satisfy themselves as to the working order and condition. If a property is unoccupied at any time there may be reconnection charges for any switched off/disconnected or drained services or appliances - All measurements are approximate. **THINKING OF SELLING?** If you are thinking of selling your home or just curious to discover the value of your property, Hunters would be pleased to provide free, no obligation sales and marketing advice. Even if your home is outside the area covered by our local offices we can arrange a Market Appraisal through our national network of Hunters estate agents.